

Pebble Beach Drive House Lot - .3685 acres

Lower Valley

MLS# 419546

CI\$328,000

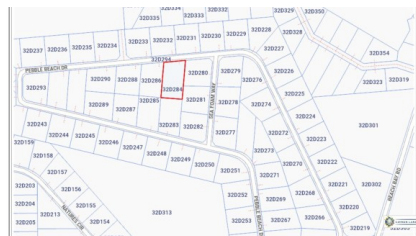



Zane Kuttner
+1 (345) 321-4611
zane.kuttner@remax.ky

Discover the perfect opportunity to bring your dream project to life on this spacious .3685-acre parcel of vacant land. Nestled in a desirable location, this property offers ample room for a custom home.

This lot combines privacy with proximity. Enjoy the peaceful surroundings while being just minutes away from schools, shopping, dining, and essential services. Also a short walk to Beach Bay Public Beach and the new site for the Mandarin Oriental Residences.

Sitting at between 31-32 feet above sea level this lot is high and dry.

Whether you’re looking to build now or hold as a future investment, this lot is an excellent addition. Don’t miss out on this chance to secure a great piece of property with endless potential.

Property Features

Type	Status	View
Land (For Sale)	New	Garden View
Listing Type	Width	Depth
Low Density Residential	100.00	165.00
Block/Parcel	Area	
32D / 284	50	